

# CACO, Inc., Window Fashions **Side Channel System**

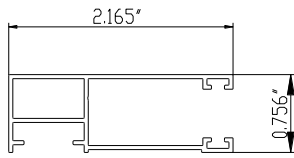

**Side Channel**

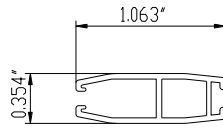

**Slim Bottom Bar**

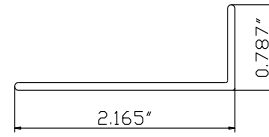

**L Channel**

## 1. **Material:**

Extruded Aluminum Side Channel 6063-T5; wall thickness 1 mm (.03937008-inch)  
Temper: Cooled from an elevated temperature shaping process and then artificially aged. Applies to products that are not cold worked after cooling from elevated temperature shaping process, or in which the effect of work in flattening or straightening may not be recognized in mechanical property limits.

## 2. **Specification:**

ASTM=B221, FEDERAL=QQ-A-2009, AMSE=SB221, AMS=4156

## 3. **Chemical Composition Limits (%):**

Silicon 0.40, Iron 0.35, Copper 0.1, Magnesium 0.45-0.9, Chromium 0.1, Zinc 0.1, Titanium 0.1, and Aluminum makes up the remaining percentage.

## 4. **Mechanical Properties:**

Tension Strength ksi = 27

Hardness Brinell number = 60

Fatigue endurance limit ksi =10

Average Coefficient of Thermal Expansion: 68° to 212°F per = 13.0

Resistance to Corrosion: Superb corrosion resistance and ready weld ability make this heat treatable alloy great for Stress Corrosion Cracking: No known instance of failure in service or in laboratory test.

## 5. **Surface Finishes:**

### **Painted:**

CACO side channels use high quality powder coated paints, which are highly resistant to scratches and abrasion. All profiles come in three standard colors: White, Bronze and Black.

### **Anodized:**

CACO side channels are also offered in a high quality anodized aluminum finish that is resistant to abrasion and corrosion.

## CACO, Inc., Window Fashions

119 Perma R Road

Johnson City, TN 37604

Customer Service 800-552-5278 • Fax 866-926-5836

Web site: [www.cacoinc.com](http://www.cacoinc.com) • [customerservice@cacoinc.com](mailto:customerservice@cacoinc.com)

# SERENITY ROLLER SHADE WITH OPTIONAL SIDE CHANNELS

POWDER COATED COLORS: WHITE, BRONZE AND BLACK

NOTE: A 1-inch deduction to the fabric width on each side from the end of the tube will be made to accommodate proper alignment within the side channels

AVAILABLE 3" OR 4" FASCIA

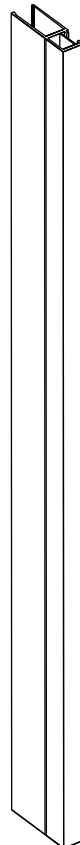
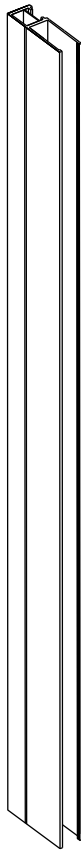
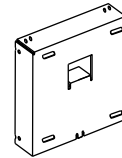
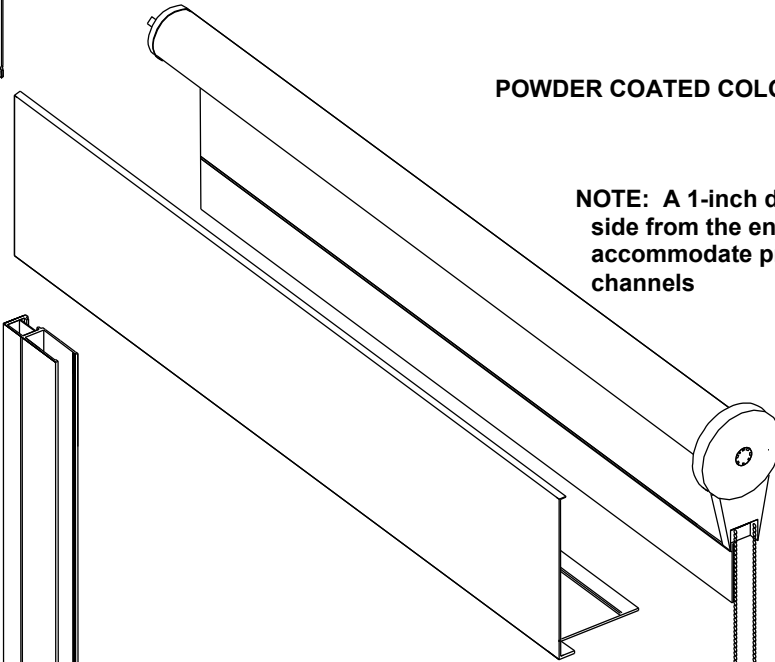
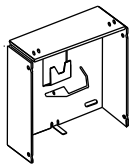

SILL CHANNEL  
1.063"H X 0.354"D

SIDE CHANNELS  
2.165"W X 0.756"D

Extruded aluminum 6063-T5; wall thickness 1mm

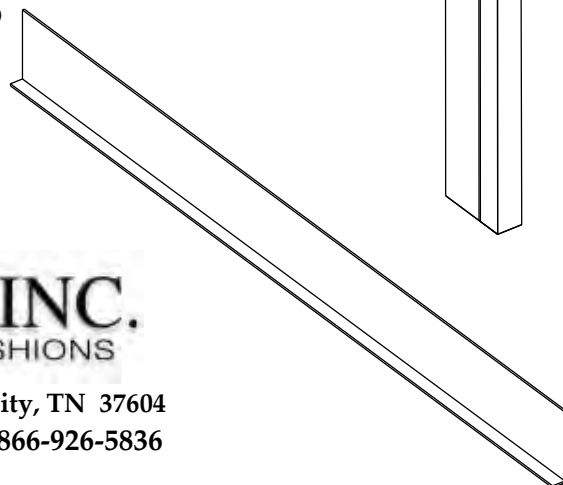

**CACO, INC.**  
WINDOW FASHIONS

119 Perma R Road, Johnson City, TN 37604  
Phone: 800-552-5278 Fax: 866-926-5836